

Witham Way Country Park

Park in the designated car park next to Boston Town FC Stadium. Alternatively, start your walk from the town's Market Place (see instructions below and map overleaf).

1. Start at the Assembly Rooms and walk towards The Britannia Pub, continue straight on to St Botolph's Church (*The Stump*).
2. Turn left over the footbridge, 50 yards before the church.
3. Turn right off the footbridge keeping the river on your right. Go straight ahead to the Grand Sluice Bridge, partly road but the majority is footpath with ample seating facing the river.
4. Cross the road, turn right over the Grand Sluice Bridge (*care must be taken here*) turn left off the bridge pass under the rail bridge, then straight ahead passing the Witham Tavern on your right and the marina on your left. Continue straight ahead through zig zag sleepers. When arriving at five railway type signal signposts, you are entering Witham Way Country Park.
5. Turn right here to approach the picnic and play area for a welcome sit down or turn left to the signed butterfly area (*right takes you to the car park*).
6. On return: you can use the alternative route to the town centre via Witham Place. Cross at Norfolk Street into Witham Place and Wormgate, passing close to The Stump.

How to get to Witham Way Country Park

Distance
2¼ miles
3.6 km

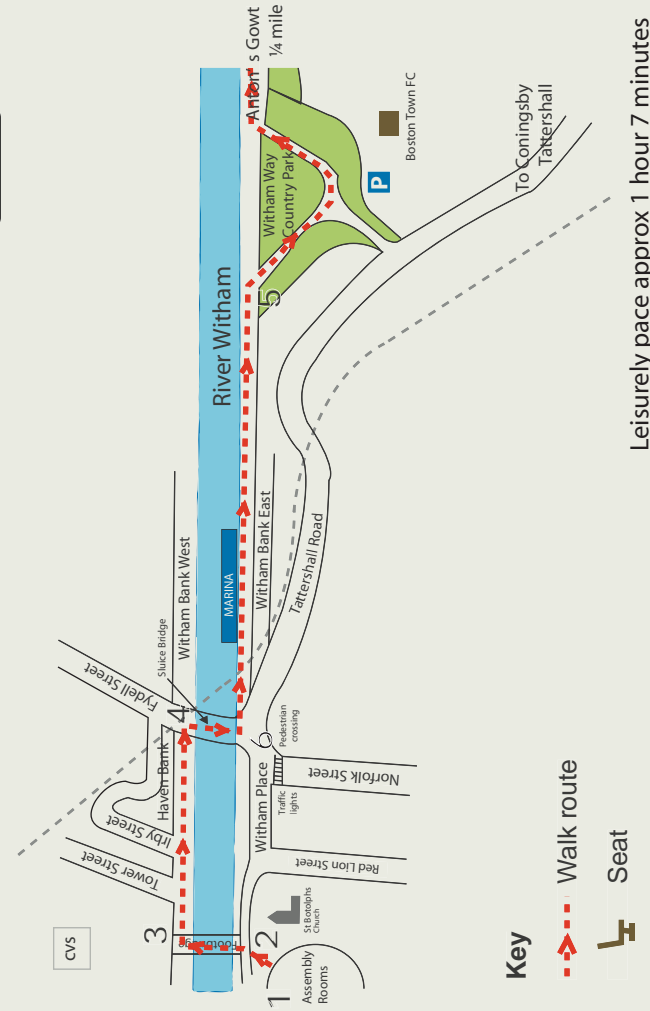

Leisurely pace approx 1 hour 7 minutes

Walkers, courtesy of Peter Norton



Witham Way Country Park

2

Areas of Interest

The main entrance is next to Boston Town Football Club on Tattershall Road. You can also get to the park via Sluice Bridge and Boston Marina as the map illustrates (see reverse).

The 38 acre park was once used as allotments. The site is owned by Boston Borough Council and linked by hard weather paths that are accessible to all abilities. A cycle path along the banks of the Witham passes through the park, which used to be the Boston to Lincoln railway line that closed in 1963.

The site has areas of shrub and grassland that attract a variety of wildlife including wildflowers, yellowhammers, butterflies and dragonflies. Grebes and other waterbirds can be seen on and along the River Witham.

Seating for watching the world go by, and informal grass paths increase the users enjoyment of the park. There is also a picnic area, so you can wile away those sunny afternoons. Trees native to this park include willow, birch and oak.

The park is maintained by Boston Borough Council and the "Friends of Witham Way Country Park" Group. These are a community group of volunteers who give their time for the "love of it".

Dogs are welcome but please respect this area.

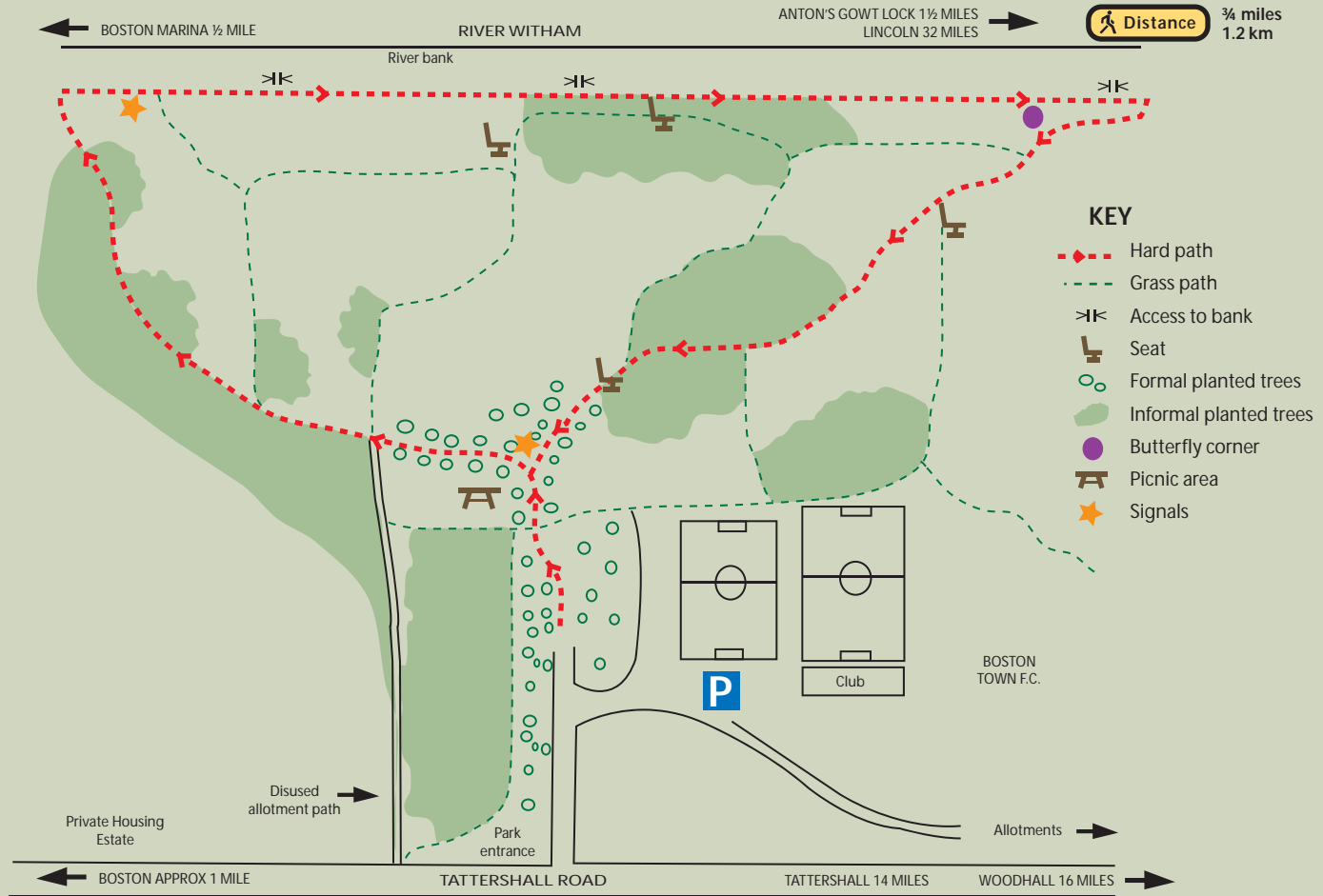

If you would like to extend this walk continue on to Walk 3 Witham Walk

Leisurely pace approx 20 minutes